

EU2022.CZ

Czech Presidency of the Council
of the European Union

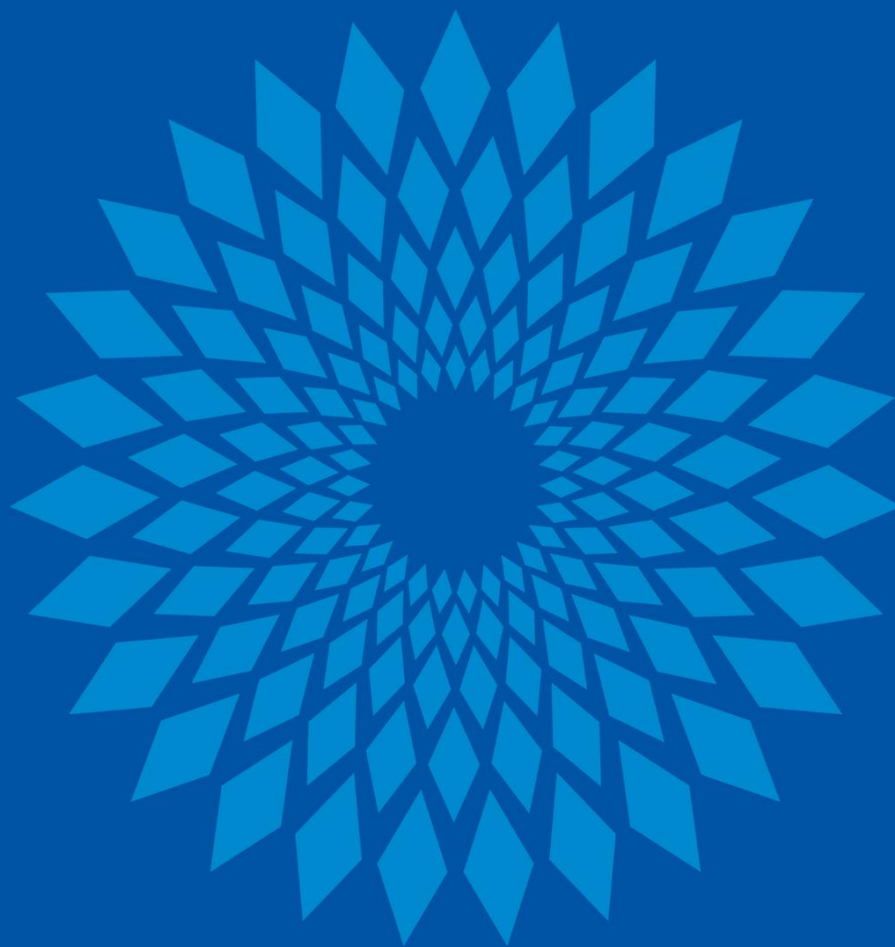

Practical Information Note

European Strategy Forum
on Research Infrastructures

Brno, Czech Republic
18 – 19 October 2022

PROGRAMME

TUESDAY, 18th OCTOBER 2022

- 08⁰⁰ – 12⁰⁰ Accreditation at the [Hotel Passage](#)
- 09⁰⁰ – 12⁰⁰ ESFRI Executive Board meeting at the Hotel Passage
- 12⁰⁰ – 12³⁰ Bus transfer to the [Masaryk University](#) Campus in Brno–Bohunice
(meeting point for the transfer in front of the Hotel Passage)
- 12³⁰ – 13³⁰ Buffet lunch
- 13³⁰ – 17⁰⁰ ESFRI Forum Plenary meeting at the Masaryk University Campus
- 17⁰⁰ – 18⁰⁰ Site-visit to research infrastructures at the Masaryk University Campus
- 18⁰⁰ – 18³⁰ Bus transfer to the hotels
- 19⁰⁰ – 19¹⁵ Bus transfer to the [Brno Observatory and Planetarium](#)
(meeting points for the transfer in front of the hotels)
- 19¹⁵ – 22¹⁵ Buffet dinner
- 22¹⁵ – 22³⁰ End of the dinner and return to the hotels





EU2022.CZ

WEDNESDAY, 19th OCTOBER 2022

09⁰⁰ – 12⁰⁰ ESFRI Forum Plenary meeting at the [Hotel Passage](#)

12⁰⁰ – 13³⁰ Buffet lunch

13³⁰ Launch of ICRI

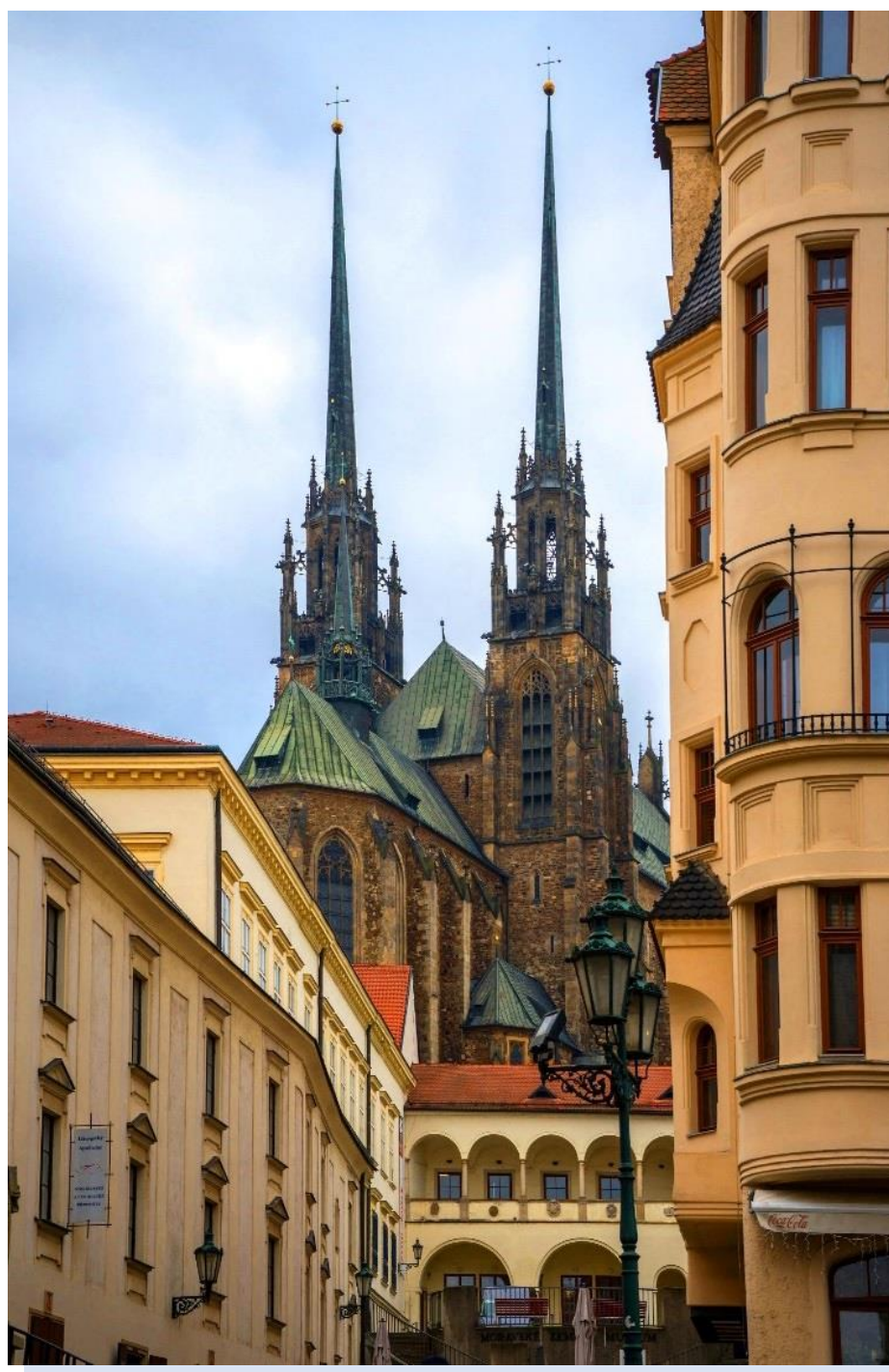

GENERAL INFORMATION

The Czech Presidency of the Council of the European Union (CZ PRES) would like to invite the delegates to the **European Strategy Forum on Research Infrastructures (ESFRI)** to attend their 81st plenary meeting, to be held on 18th – 19th October 2022 in Brno as a back-to-back event to the International Conference on Research Infrastructures (ICRI).

For your visit, CZ PRES has prepared the following brief Practical Information Note (PIN). **Please, note that all information may be subject to change, in which case it will be communicated by CZ PRES in due time.** This PIN provides you with general information on the logistical and organisational aspects to help you prepare for the event in advance.

Public health measures

As of 9th April 2022, the protective measures regarding the **conditions of entry into the Czech Republic in relation to the epidemic of Covid-19 have been suspended.** Given that, entry into the Czech Republic is no longer subject to any special epidemiological conditions to prevent the spread of the Covid-19 disease. The entry-ban for foreigners from third countries and the obligation to prove infection-free status have been lifted.

To ensure the safe conduct of the meeting, the rules minimizing the Covid-19 spread disease will be set in a way to reduce the risks potentially jeopardizing the event. Regular monitoring and assessment of the epidemiological situation will be provided. Delegates should observe basic hygiene measures during the meeting (i.e., hand and respiratory hygiene, etc.).

In accordance with the current Czech anti-epidemiological regulations, **face masks and respirators are voluntary in all areas.** In the case of worsening of the epidemiological situation, changes in preventive measures will be notified in sufficient advance.

The most up-to-date information on the Covid-19 measures within the Czech Republic can be found at the website of the **[Covid-19 Portal](#)**. Please, check the portal before the travel.

Registration

CZ PRES kindly asks the ESFRI delegates to register at their earliest convenience through the ESFRI website at <https://www.esfri.eu/registration-81st-esfri-forum-meeting>.

The online registration system will be open until Friday, 30th September 2022. Please, note that only registered delegates will have access to the programme venues.

Badges

Access to the programme venues require a valid personalised badge. **Badges will be distributed at the Hotel Passage on Tuesday, 18th October 2022 from 8:00 to 12:00.** Please, make sure to wear your badge visibly at the meeting venue and other official programme venues at all times.



Transportation

Brno can be reached by plane, train or bus.

Although there is an international airport situated in Brno – the Brno Tuřany Airport – it is highly recommended to use the services of the [Vienna International Airport](#).

Regular bus connection from the Vienna International Airport to Brno is available. The trip takes about two hours and the service is provided by a number of operating companies, in particular [Student Agency](#), [RegioJet](#), [Flixbus](#) and [Gepard Express](#).

The [Vienna Main Train Station](#), very well connected to the Vienna International Airport, provides train transport to Brno with the [České dráhy](#) company.

Public transport in Brno is provided by the [South Moravian Integrated Public Transport System](#). Tickets for zones 100 and 101 are valid for public transport throughout the city of Brno and can be paid contactless in the vehicles.



The programme of the ESFRI session will start with the ESFRI Executive Board meeting, to be held at the [Hotel Passage](#). Then, the ESFRI session will continue with the ESFRI Forum Plenary meeting, to be held at the [Masaryk University](#) Campus in Brno-Bohunice.

The transfer from the Hotel Passage to the Masaryk University Campus in Brno-Bohunice will be organised by CZ PRES. The meeting point for the transport will be in the lobby of the Hotel Passage, which is situated within walking distance of the city centre.

To get to the Hotel Passage from the Brno Main Railway Station, take the Tram No 1 in the direction of “Řečkovice” and go to the tram station “Antonínská”.

To get to the Hotel Passage from the Brno Main Bus Terminal Zvonařka, take the Tram No 12 in the direction of “Technologický park”, go to the tram station “Hlavní nádraží” and change for the Tram No 1 in the direction of “Řečkovice” to proceed to the tram station “Antonínská”.

For transportation between the programme venues, buses will be provided by CZ PRES.

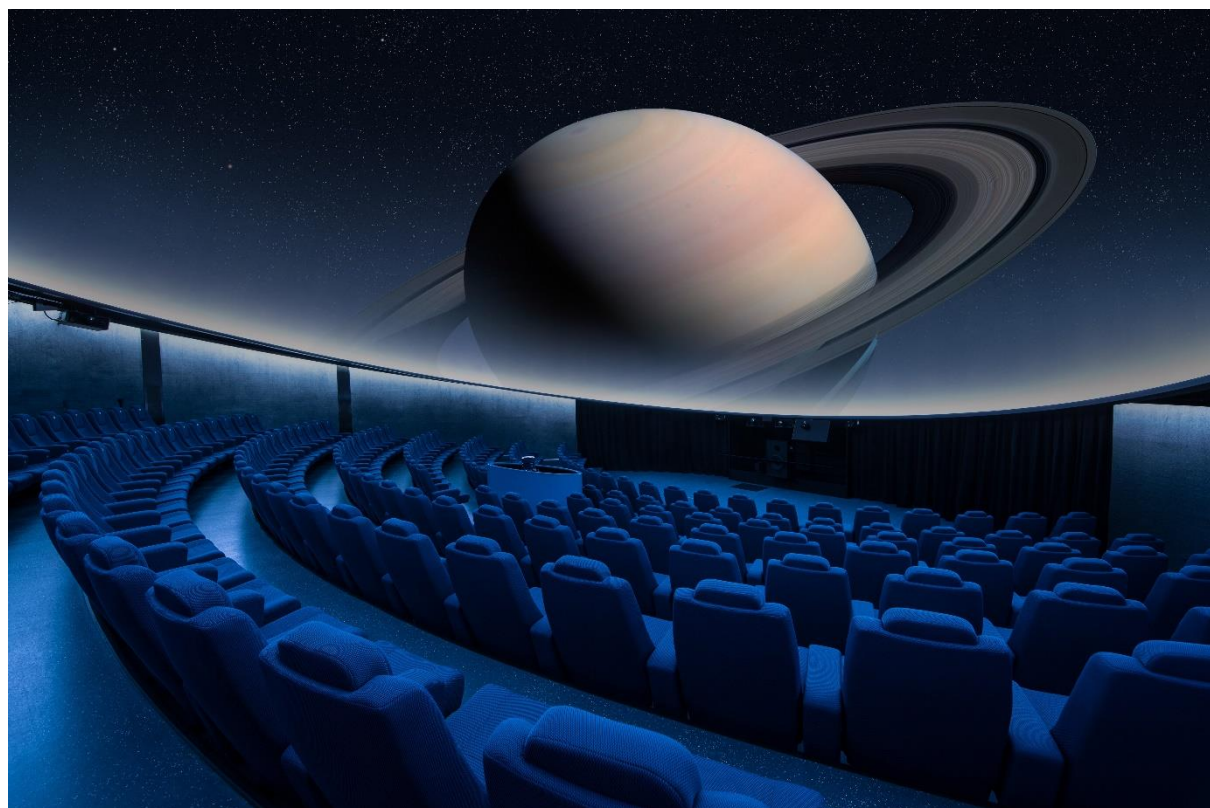

Accommodation

The accommodation expenses during the event shall be paid by participants themselves. CZ PRES selected the following hotels and secured discounted prices there. The hotels are recommended due to their capacity and location.

- **[Hotel Passage](#)** – for booking, please, use the following [link](#) and the promo code “ICRI2022”.
- **[Hotel International Brno](#)** – for booking, please, use the following [link](#) and the promo code “ICRI2022”.
- **[Hotel Continental Brno](#)** – for booking, please, contact the accommodation facility at viktorova@continentalbrno.cz or recepce@continentalbrno.cz using the promo code “ICRI 2022”.
- **[Hotel Barceló Brno Palace](#)** – for booking, please, use the following [link](#).

It is highly recommended to make booking as soon as possible as the availability of rooms is not guaranteed by CZ PRES.



Meeting venues

The ESFRI Executive Board meeting will be held at the [Hotel Passage](#).

The ESFRI Forum Plenary meeting on Tuesday, 18th October 2022 will be held at the [Masaryk University](#) Campus in Brno–Bohunice.

The ESFRI Forum Plenary meeting on Wednesday, 19th October 2022 will be held at the [Hotel Passage](#).

CZ PRES will provide all necessary complementary services, such as a cloakroom, internet connection, working facilities, etc. The Wi-Fi password will be provided at the locations. If you require photocopying, printing or scanning during the ESFRI meeting, please, inform us at ESFRI@msmt.cz. There will be printing and photocopying point at the venues.

Contact

Should you have any questions concerning the programme of the ESFRI meeting or the organisational matters, please, do not hesitate to contact CZ PRES at the general address of the event ESFRI@msmt.cz or Ms Kristýna Veitová at kristyna.veitova@dzs.cz.

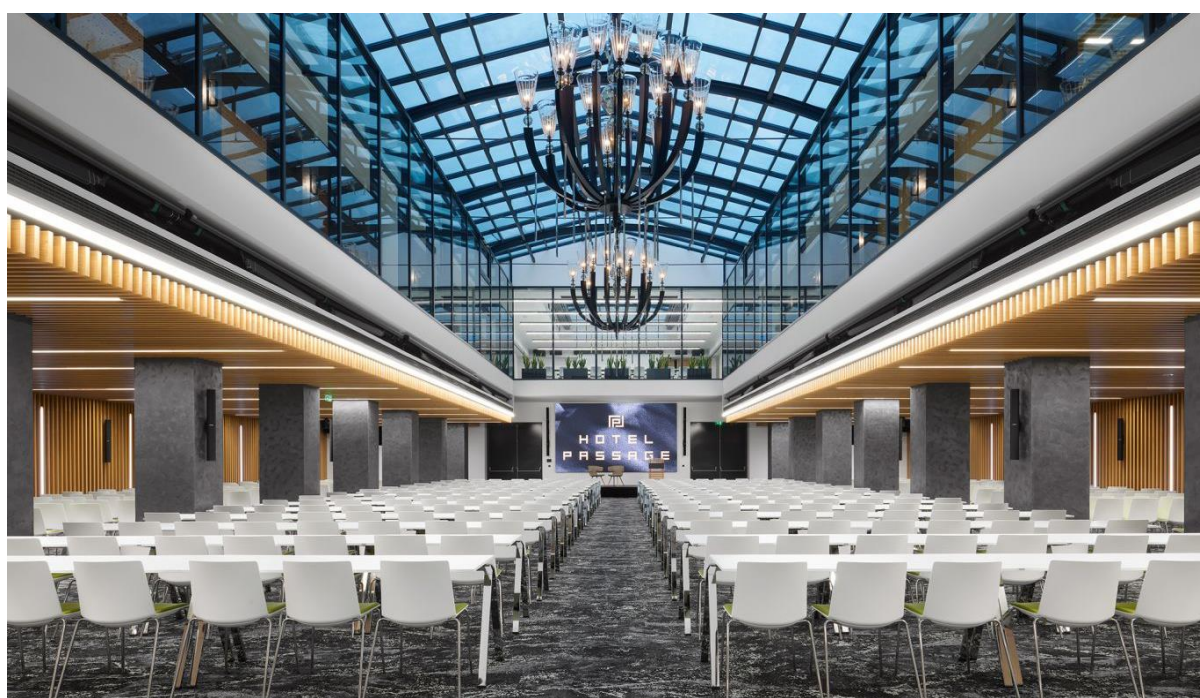

Practical information

Emergency: 112 (fire brigade, medical assistance)

Electricity: The voltage in the Czech Republic is 230V, 50 Hz

Local time: Central European Summer Time Zone (CEST) – GMT +2:00

Country code: Czech Republic (CZ) +420

Currency: Czech crown, for exchange rates, please, see the [Czech National Bank website](#)

Tap water: Czech water is regularly tested for quality and is safe to drink

Organisers

Ministry of Education, Youth and Sports

Karmelitská 529/5, 118 12 Prague 1, Czech Republic

Czech National Agency for International Education and Research

Na Poříčí 1035/4, 110 00 Prague 1, Czech Republic

CZ PRES

The official [CZ PRES website](#) contains information on all the topics related to CZ PRES available in the Czech, English and French languages.

